

12345 WEST ALAMEDA PARKWAY
Lakewood, Colorado 80228



PROPERTY FEATURES

- **Broker incentives available**
- Great Lakewood location near 6th Ave. and Union Boulevard
- Near the West Light Rail Station, St. Anthony's Hospital and the Denver Federal Center
- High quality building with renovated common areas
- Landlord will provide tenant finish
- On-site property management
- On-site conference facility
- 2021 Energy Star Certified Building

PROPERTY SPECIFICATIONS

Available:	Suite 210	1,489 - 1,755 RSF
	Suite 204	3,481 - 7,815 RSF
Lease Rate:		\$16.00-\$18.00/SF FSG
Lease Term:		3-5 Years
Building Area:		75,000 SF
Number of Stories:		Three
Elevator:		Yes
Year Built:		1980
Parking:		5/1,000 RSF

FOR MORE INFORMATION CONTACT:

JAMIE MACBETH

jmacbeth@gcgcre.com | 720.476.5229

TIM P. ROGERS

tprogers@gcgcre.com | 720.476.5225

T. BLAKE ROGERS

tblakerogers@gcgcre.com | 720.530.5788



GENESEE
COMMERCIAL
GROUP, LLC

12345 WEST ALAMEDA PARKWAY
Lakewood, Colorado 80228

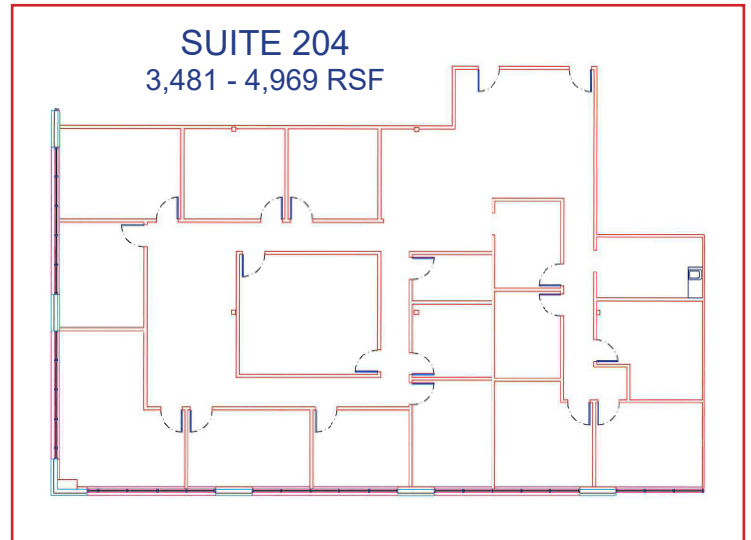
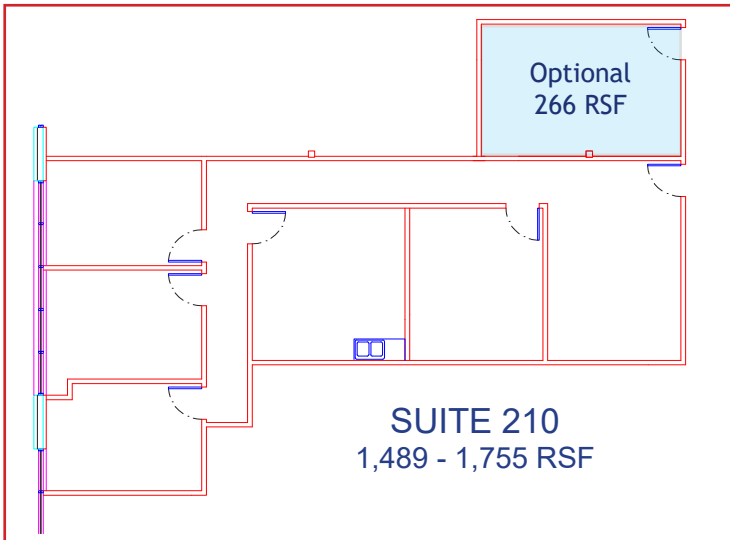

FOR MORE INFORMATION CONTACT:

JAMIE MACBETH

jmacbeth@gcgcre.com | 720.476.5229

TIM P. ROGERS

tprogers@gcgcre.com | 720.476.5225

T. BLAKE ROGERS

tblakerogers@gcgcre.com | 720.530.5788

GENESEE COMMERCIAL GROUP, LLC | 710 KIPLING STREET, SUITE 403 | LAKEWOOD, COLORADO 80215 | WWW.GCGCRE.COM

No warranty or representation is made as to the accuracy of the foregoing information. Terms of sale or lease and availability are subject to change or withdrawal without notice.