



GENESEE
COMMERCIAL
GROUP, LLC

For Lease | Office

8805 W. 14th St.

Lakewood 80215



T. Blake Rogers - 720.530.5788
tblakerogers@gcgcre.com

Tim P. Rogers - 303.641.4080
tprogers@gcgcre.com

Leasing Specifications

Lease Rate: See Page 2
 Available SF: 730 rsf - 1,254 rsf
 Parking: 5/1000
 Year Built: 1980
 Elevator: Yes
 Building Area: 30,048 sf
 Access: Colfax & Garrison
 Stories: 3
 Lease Term: 3 Yrs Minimum



AVAILABILITY

SUITE #	SIZE	DESCRIPTION
120	755 RSF	2 PRIVATES (1 ON GLASS); RESTROOM; STORAGE; RECEPTION

Suite 120
755 rsf
\$1,200
Per Month

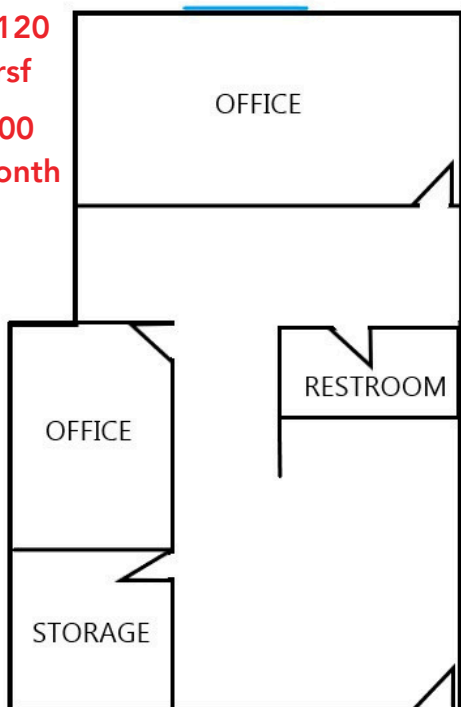

Suite 130
810 rsf

Property Summation



Abundant Food and Retail Options Nearby



Close Proximity to 6th Avenue



Less than 10 min commute to Foothills



Less than 15 min commute to CBD



Walking Distance to Light Rail & Bus



Abundant Parking



TI Packages Available



T. Blake Rogers - 720.530.5788
tblakerogers@gcgcre.com

Tim P. Rogers - 303.641.4080
tprogers@gcgcre.com

Genesee Commercial Group | 710 Kipling Street Suite 403 | Lakewood, CO 80215

