



**5808 S. RAPP STREET**  
Littleton, Colorado 80120



## PROPERTY FEATURES

- New Aggressive Ownership
- Convenient access to C-470 and downtown Littleton
- Professionally Managed
- Plenty of Parking
- Functional layouts
- Creative Outside-the-Box Approach to Deals

## PROPERTY SPECIFICATIONS

<b>Lease Rate:</b>	\$21.00/RSF Full Service Gross
<b>Building Size:</b>	30,678 RSF
<b>Elevator:</b>	One
<b>Stories:</b>	Two
<b>Year Built:</b>	1983
<b>Parking:</b>	2.05/1000 SF

**FOR MORE INFORMATION CONTACT:**

**T. BLAKE ROGERS**

tblakerogers@gcgcre.com | 720.476.5227

**TIM ROGERS**

tprogers@gcgcre.com | 720.476.5225

**AVAILABILITY**

SUITE #	SIZE	DESCRIPTION
240	435 RSF	One Office on Glass
235	533 RSF	Three Privates (Two on Glass); Open Area
225	540 RSF	Two Privates on Glass; Open Area
150	588 RSF	One Private and One Storage Closet; Remainder Open Area
230	900 RSF	Two Privates on Glass; Conference Room; Open Area
245	1,092 RSF	Two Privates on Glass; Break Room; Storage; Open Area
250	1,285 RSF	Four Privates (One on Glass); Open Area

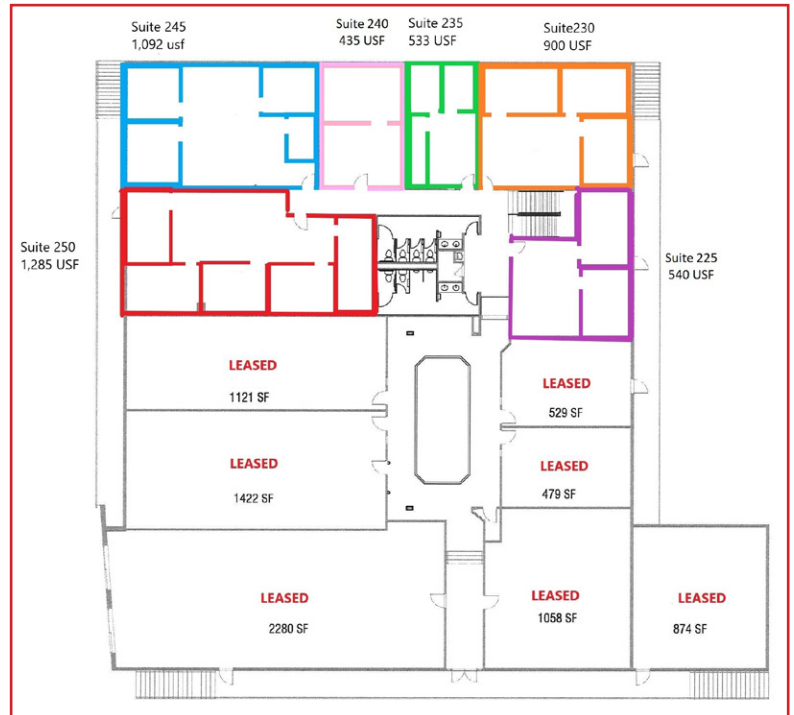
**FOR MORE INFORMATION CONTACT:**

**T. BLAKE ROGERS**  
 tblakerogers@gcgcre.com | 720.476.5227

**TIM ROGERS**  
 tprogers@gcgcre.com | 720.476.5225

GENESEE COMMERCIAL GROUP, LLC | 710 KIPLING STREET, SUITE 403 | LAKEWOOD, COLORADO 80215 | WWW.GCGCRE.COM