

7220 W. JEFFERSON AVENUE
Lakewood, Colorado 80235



PROPERTY FEATURES

- Local ownership and management
- Updated building and common areas
- Abundant nearby amenities
- Huge parking lot on 3 sides of building
- Connectivity through Comcast
- Security code after hours building access
- Most suites have individual HVAC control
- Two electric vehicle charging stations

PROPERTY SPECIFICATIONS

Available:	Suite 204	850 RSF
Building Square Feet:		41,159 SF
Lease Rate:		\$15.50/SF FSG
Parking:		4/1,000 SF
Stories:		Four
Elevators:		One
Year Constructed:		1981 (remodeled 2017)

FOR MORE INFORMATION CONTACT:

RENÉE SPICER
rspicer@gcgcre.com | 720.476.5226

WILLIAM NETWAL
wnetwal@gcgcre.com | 720.476.5228

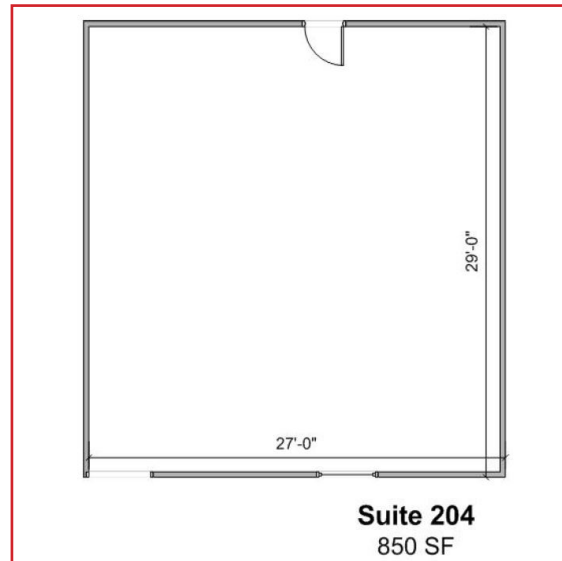
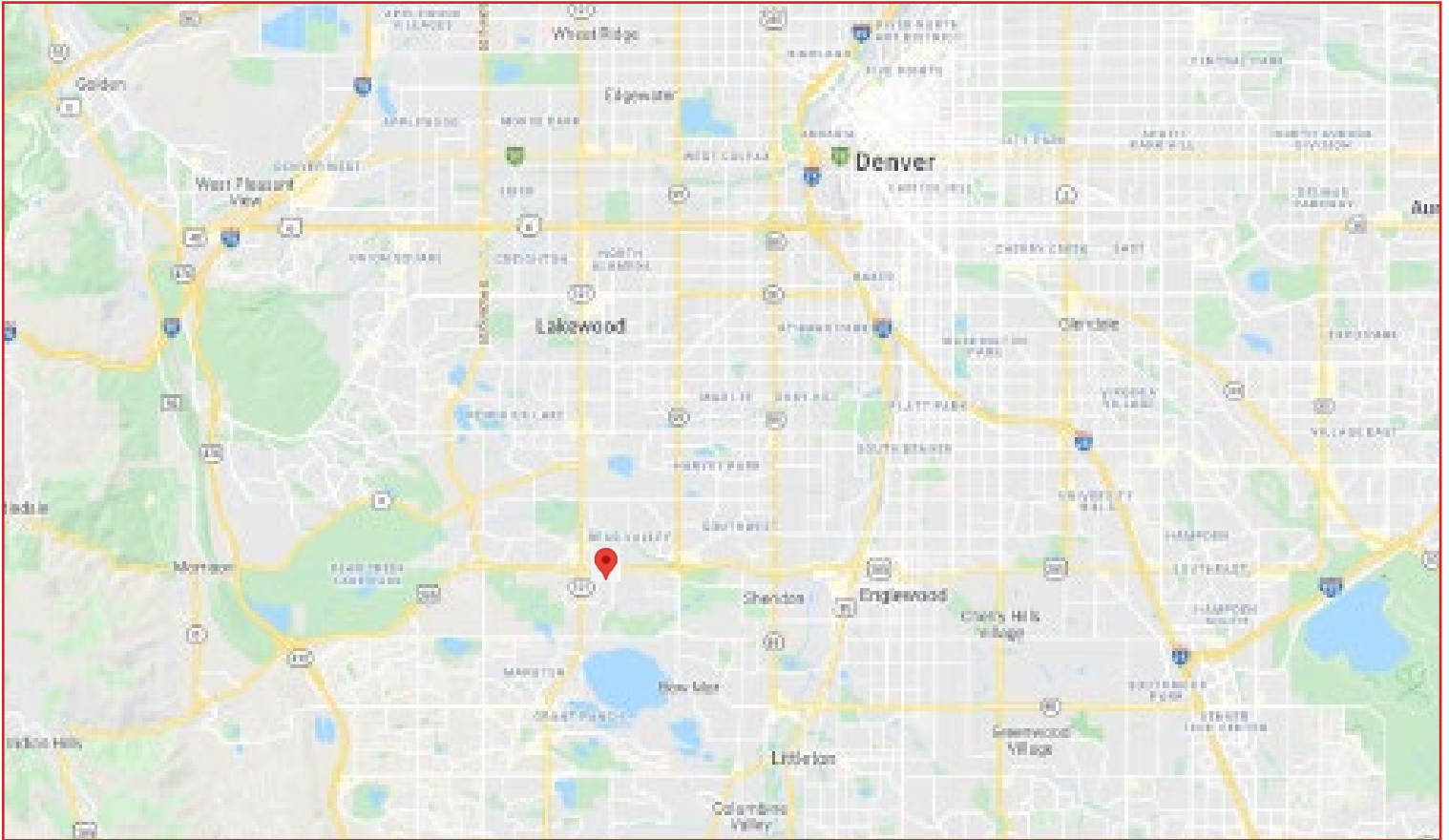

FOR MORE INFORMATION CONTACT:

RENÉE SPICER

rspicer@gcgcre.com | 720.476.5226

WILLIAM NETWAL

wnetwal@gcgcre.com | 720.476.5228

GENESEE COMMERCIAL GROUP, LLC | 710 KIPLING STREET, SUITE 403 | LAKEWOOD, COLORADO 80215 | WWW.GCGCRE.COM